

PERI Services

Cleaning and Repair Service



Lasting quality of your construction work
Long service life of your formwork equipment
Expertise of the manufacturer

Quality direct from the manufacturer - always in your proximity

PERI cleaning and repair services

The use of high quality formlining is a prerequisite for a high rate of utilisation and the associated cost-effectiveness of a modern formwork system.

The steel frame forms the supporting structure for the formlining - a high degree of evenness and excellent frame stability are therefore equally important for achieving good concrete results.

As the formwork panels are subject to considerable mechanical stresses during their use, regular maintenance is indispensable.

PERI offers professional and cost-effective cleaning and repair of your materials at many locations around the world - for long-lasting care of your formwork inventory.

Plant 1 of PERI GmbH in Weissenhorn has an area of around 280,000 m² and is an innovation and development centre. In Weissenhorn, 95% of all PERI system equipment for world-wide sales is produced.

The PERI services

- High capacities available in a Germany-wide network of service centres
- Highly skilled personnel and the very latest plant technology
- Continuous development of our products
- On-site individual consultation and agreement of services to be provided with the PERI sales engineer

Your benefits

- Short journey times and fast processing
- High quality and reliability
- Material assessment using the latest technology
- Cost-effective solution oriented to your materials inventory

Best possible condition of your formwork inventory connected with optimal concrete surface results.



PERI's customer service for your formwork

Our services in more detail



	Cleaning Service RS	Cleaning Service "Small" RK	Cleaning Service "Large" RG
Approximate estimation of the expected scope of service through the sales engineer	■	■	■
Machine cleaning of your formwork materials	■		
Rectifying small areas of damage to the formlining with repair discs	■		
Basic cleaning		■	■
Removal of formlining sheet	■	■	■
Drilling of holes in the steel frame		■	■
Sorting the panels and checking for damage		■	■
Agreement on the repairs to be carried out and determining the scope of service		■	■
Provision of an alternative offer if repairs are uneconomical		■	■
Cleaning of the bearing surfaces		■	■
Straightening and welding work on the frame		Invoicing on a time and materials basis	■
Sand blasting of the profiles			■
Applying a new powder coating (individual colours on request)			■
Fitting of new plastic inserts or stainless steel sleeves for large panels		■	■
Fitting of an original PERI Fin-Ply or formlining of choice	■	■	■
Sealing with joint sealant		■	■
Mounting of tie hole plugs ø 20 mm on multi-purpose panels		■	■
Disposal of the old formlining		■	■

PERI Cleaning Service RS

Thorough, careful and calculable



Efficient machine cleaning

The logistics centres are equipped with the very latest PERI panel cleaning facilities. These have been designed to handle panels with heights ranging from 30 to 330 cm, for any widths and thicknesses of up to 18 cm. Equipment such as dust extraction, continuously adjustable operating speed or the individually adjustable brush contact pressure, clean your formwork elements thoroughly and carefully.

For heavily soiled frames, we also offer you pressurized water cleaning as an optional special service.

By transferring the activities to our plant, the cleaning costs for you are calculable; in addition, you are relieved of all co-ordinating activities.



Repairs on the formlining

Additionally drilled tie holes as well as smaller areas of damage to the formwork shell, mostly caused by concrete vibrators, are repaired if required with repair veneers.

Opening of openings plugged with concrete

As part of the panel cleaning process, tie points and function holes are freed of all concrete residue.

PERI Repair Service “Small” RK

A new formlining sheet - original from the manufacturer



Coordinating the scope of service
 On delivery, your materials are first carefully checked and then the condition of all pieces is assessed. Required measures are determined, and the exact scope of service is agreed on in detail by you the customer together with our specialist staff.



Removal of formlining sheet
 Removing the formlining from the formwork element is normally carried out by a machine. Subsequently, all function holes in the steel frame are opened.



Cleaning of the bearing surfaces
 The bearing surfaces of the frame are cleaned and straightened before the new formlining is installed.

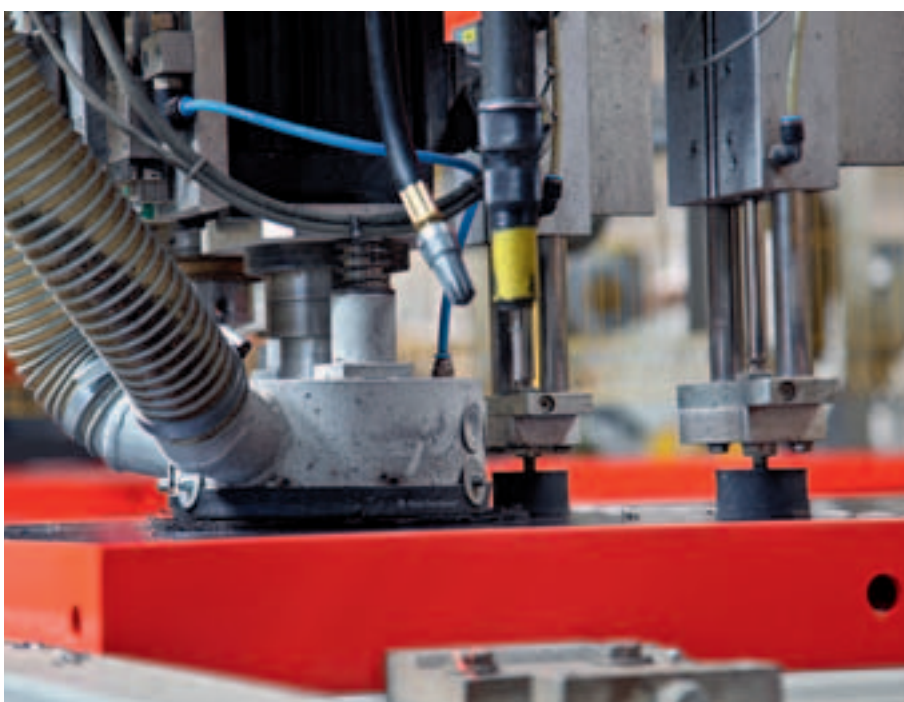

Installation of the formlining sheet
 For mounting the formlining sheets, PERI uses state-of-the-art machinery which guarantees the highest degree of accuracy.

Sealing
 The joint between the formlining sheet and frame is filled with permanently elastic joint sealer. PERI uses PACTAN® - a material with verifiable high ageing resistance and good chemical resistance.



PERI Repair Service "Large" RG

The general overhaul of your formwork



Frame repairs

The "Large" RG repair service includes metalworking operations on the frame. Where necessary, the steel frames are re-aligned and welded.

Sandblasting

The frames are prepared for the new powder coating by means of sandblasting. Through the sandblasting process, rust and old paint along with other unwanted surface deposits are removed.



before



after

PERI powder coating

The original PERI powder coating prevents concrete adhesion more effectively than painting which means the panels are particularly easy and quick to clean. In addition, the powder coating is extremely resistant and therefore very durable.



If you have any special requests regarding the colour, we would be pleased to send you an offer.

The new formlining direct from the manufacturer **PERI**

A guarantee for the best concrete surfaces

Choice of formlining

For the new formlining, PERI gives you the choice of different types and qualities:

- PERI Fin-Ply plywood sheets
- HVP plywood-plastic composite panels
- SABO-Ply plastic panels

We will be pleased to advise you thus ensuring you receive the best individual solution!

PERI Fin-Ply coated plywood 18 mm

The Fin-Ply plywood sheets have been designed to meet the highest requirements and stand out due to an excellent price-performance ratio. The sheeting consists of cross-bonded birch veneers coated with 220 g/m² reinforced phenolic resin on both sides with the edges sealed all round (BFU 100 bonding according to EN 314-2).

Enhanced seam design

The seam formation between two formlining sheets for large panels has been changed: a new milling process for the plywood joints minimizes offsets in this area.

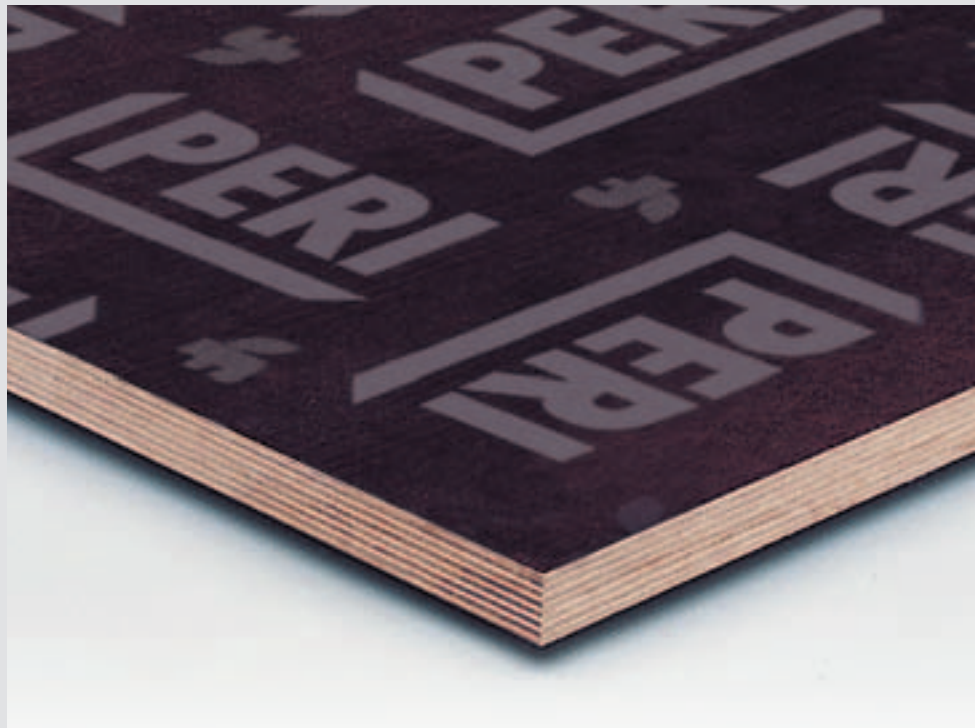
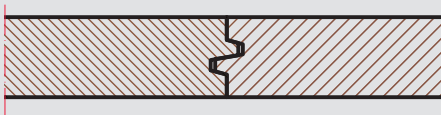

The proven PERI Fin-Ply plywood formliner has been improved once again.



Stainless steel sleeves

For the TRIO large panels and corners, the tie hole in the formlining has been strengthened by means of a stainless steel sleeve which ensures excellent durability.

HVP plywood-plastic composite panels 18 mm

The core corresponds to the proven design of the PERI Fin-Ply, likewise the rear side is coated with phenolic resin.

On the concreting side, the sheet is provided with a polypropylene coating.

SABO-Ply plastic panels 20 mm

The sandwich elements have a plastic core which is strengthened on both sides with a layer of aluminium. The plastic surface layer consists of polypropylene.

PERI Product Range



Wall Formwork

Panel Formwork
Girder Formwork
Circular Formwork
Facade Formwork
Brace Frame



Climbing Systems

Climbing Scaffold
Self-Climbing System
Climbing Protection Panel
Platform Systems



Column Formwork

Square
Rectangular
Circular



Scaffold, Stairways, Working Platforms

Facade Scaffold
Working Platform
Weather Protection Roof
Stairway Access



Slab Formwork

Panel Formwork
Beam Grid Formwork
Girder Formwork
Slab Table
Beam Formwork



Bridge and Tunnel Formwork

Cantilevered Parapet Carriage
Cantilevered Parapet Platform
Engineer's Construction Kit



Shoring Systems

Steel Slab Props
Aluminium Slab Props
Tower Systems
Heavy-Duty Props

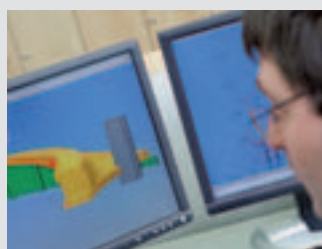

Services

Formwork Assembly
Cleaning / Repairs
Formwork Planning
Software
Statics
Special Constructions

Additional Systems
Plywood
Formwork Girders
Stopend Systems
Pallets
Transportation Containers



PERI GmbH Formwork Scaffolding Engineering

P.O. Box 1264
89259 Weissenhorn
Germany
Tel +49 (0)73 09.9 50-0
Fax +49 (0)73 09.9 51-0
info@peri.com
www.peri.com